

Check Seat① : confirmation at the time of requesting a quotation

Please share a drawing of the Wire Tend (N) installation area (posts, wire placement, etc.)

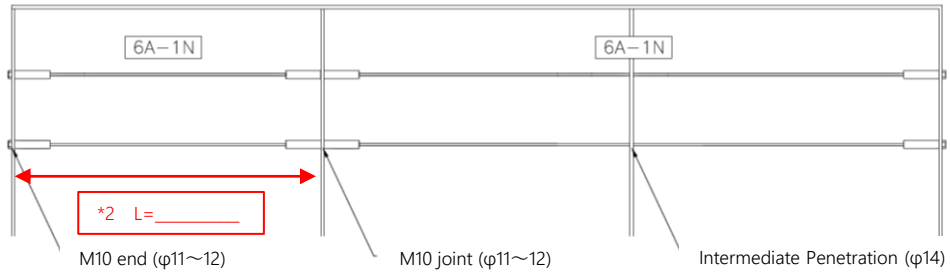

Checklist

1. Can you share a drawing of Wire Tend installation area? Yes No
2. How to tension the wire? Horizontal Sloping Horizontal and Sloping
3. How many wire tiers? 1 2 3 4 5 6 Other (_____)
4. What material is the support pole made of? Flat bar Square pipe Round pipe Other (_____)
5. What size and thickness of posts? *1 t=_____
6. What are the dimensions between posts (core dimensions or inside dimensions)? *2 L=_____
7. If sloping, what is the slope angle? _____ degrees
8. If you are also installing posts in the corners, how many posts are to be installed in the corners? Only one 2 or more

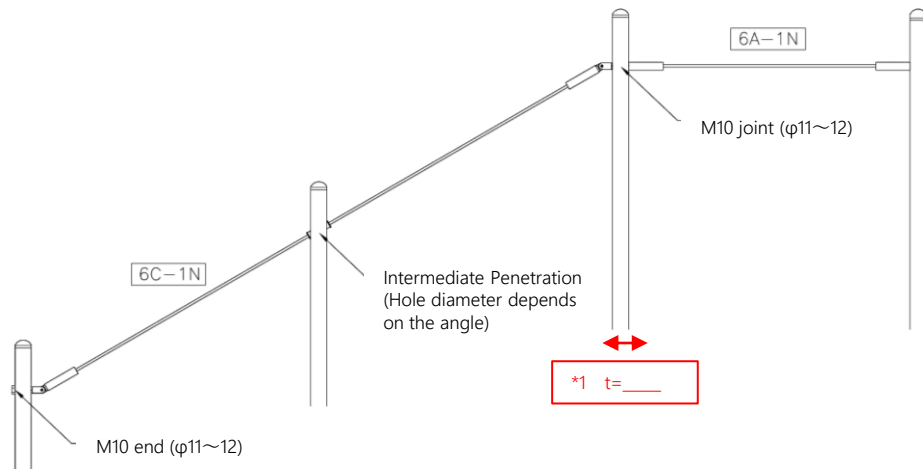

Check Seat② : confirmation of installation of corner posts

Please share a drawing of the Wire Tend (N) installation area (posts, wire placement, etc.)

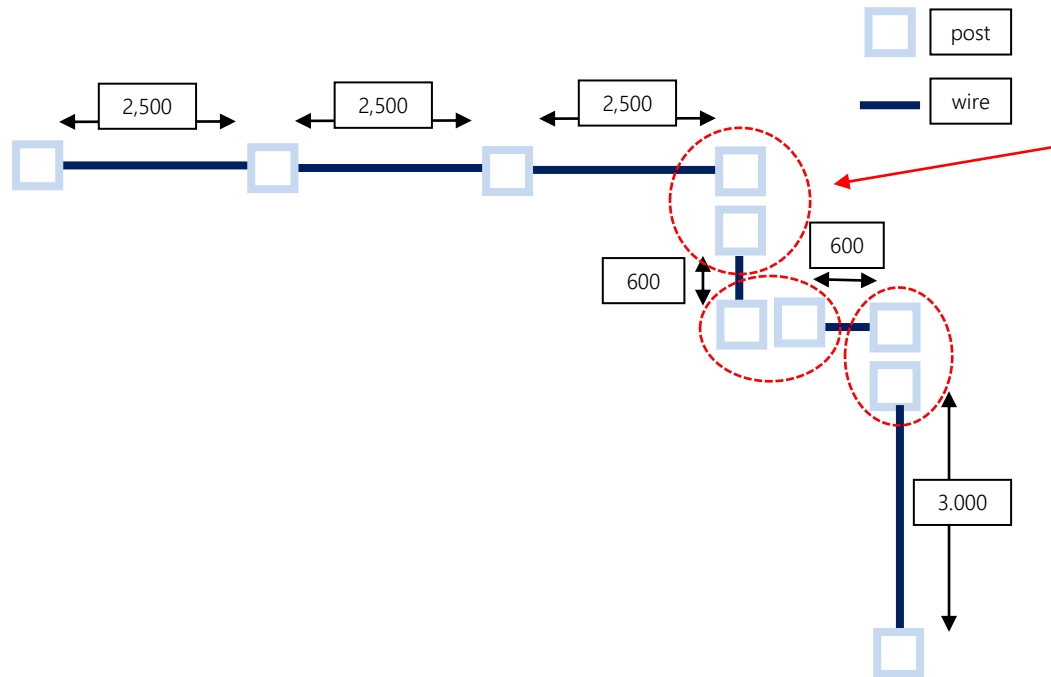

Checklist

For the corner section, the wire set can only be attached in one direction to one post.

The corner section requires two posts.

Please check if two corner posts are possible.

If two corner posts cannot be installed, wire set welding will be used in one direction.

Please confirm if welding is possible.

Wire Tend (N) 【Attention】

Precautions for installation

- Commercially available wrenches can be used for installation. (13mm, 14mm, 17mm)
- Tension adjustment is performed on the thread side. However, any errors in the dimensions between the posts can also be adjusted on the terminal side.
- When removing the security cover for maintenance, etc., grasp the cover and pull it horizontally. (If it is difficult to remove, use rubber gloves or other non-slip material.)
- M10 bolts are used for installation. The hole for the support pole should be drilled to $\phi 11-12$. However, if an intermediate post is provided and a wire protection pipe for the intermediate post (pipe diameter $\phi 16$) is used, the drilled hole should be $\phi 17$. In the case of FB, if joint bolts are not used for the intermediate strut, the drilled hole should be $\phi 14$ or more.
- Attach the supplied tamper-evident cap to the head of the end bolt after all installation is completed. When attaching the cap, tap it into place with a wooden pad or the like.
- When installed on a wooden post, the dimensions may change due to drying over time. Re-tighten the caps approximately 3 to 6 months after installation.

Notes on ordering

- Wire lengths (with threading hardware) are manufactured based on the dimensions between the posts. When ordering, please inform us of the inside or core dimensions of the support columns.
- Almost all shapes, materials, and dimensions of support poles, such as flat bars, round pipes, square pipes, and wooden poles, can be accommodated.
- The material is SUS304. When used in coastal areas, SUS316 is available by special order.
- Since this product is designed to be used in a system and safety is taken into consideration, individual parts are not sold separately.
- If there is a support pole in the middle, we recommend the use of a wire protection pipe for the middle pole to protect the wire. (Support pole: square pipe, round pipe)
- End bolts and joint bolts are sold separately.
- Test values are for wire diameter $\phi 6$. ($\phi 5$ is also available)
- Wire cannot be cut on site.
- Although rust-resistant material is used, rust may occur depending on the installation location and environment. However, even if rusting occurs, there is no functional problem.